

# Making a Sheet Wall Panel for East Kingdom Royal at Pennsic

Choose a medium-weight woven fabric (around 5-6 oz/sq yd), ideally a poly/cotton-blend such as trigger or poly/cotton poplin.

Look for fabric that comes in a 60" width and cut it to 74" length. (When buying fabric by the yard, the edges are rarely cut perfectly straight, so buy 2 1/4 yards and then cut it to measure.)

Fold over the selvage on the long sides by 1/2" and stitch down.

Fold top and bottom edges over by 1/2", twice, and stitch down.

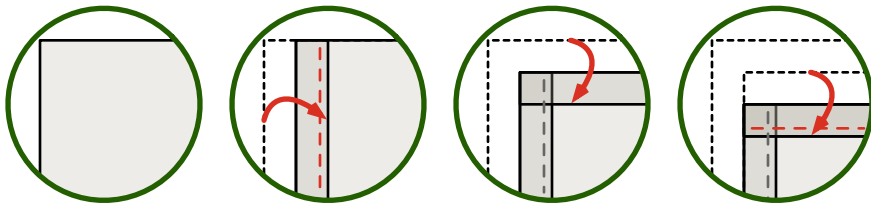

For the eight attachment points, make reinforcing panels out of light leather or heavy-weight fabric. The four corner pieces should be 3" triangles while the four side pieces are 2" squares.

Attach these to the wall panel by sewing securely along all sides.

Punch a hole and set a 3/8" or 1/2" grommet through each one.

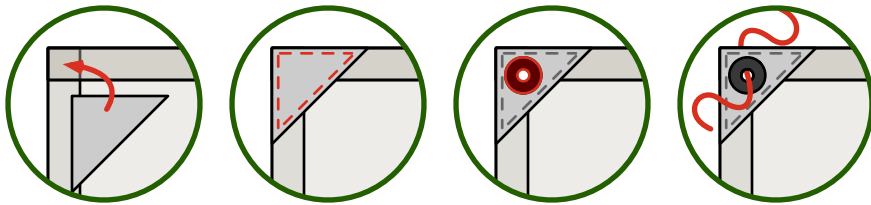

Provide eight cords made of nylon or another synthetic material to attach the panel to the fenceposts, each about 36" long.

Shoelaces work well. If you cut these from a longer rope, finish the ends with aglets or heat-shrink tubing so they don't unravel.

Fill the other side with your design in acrylic paint or equivalent.

